

SMOOTH FITNESS

UB4 UPRIGHT BIKE

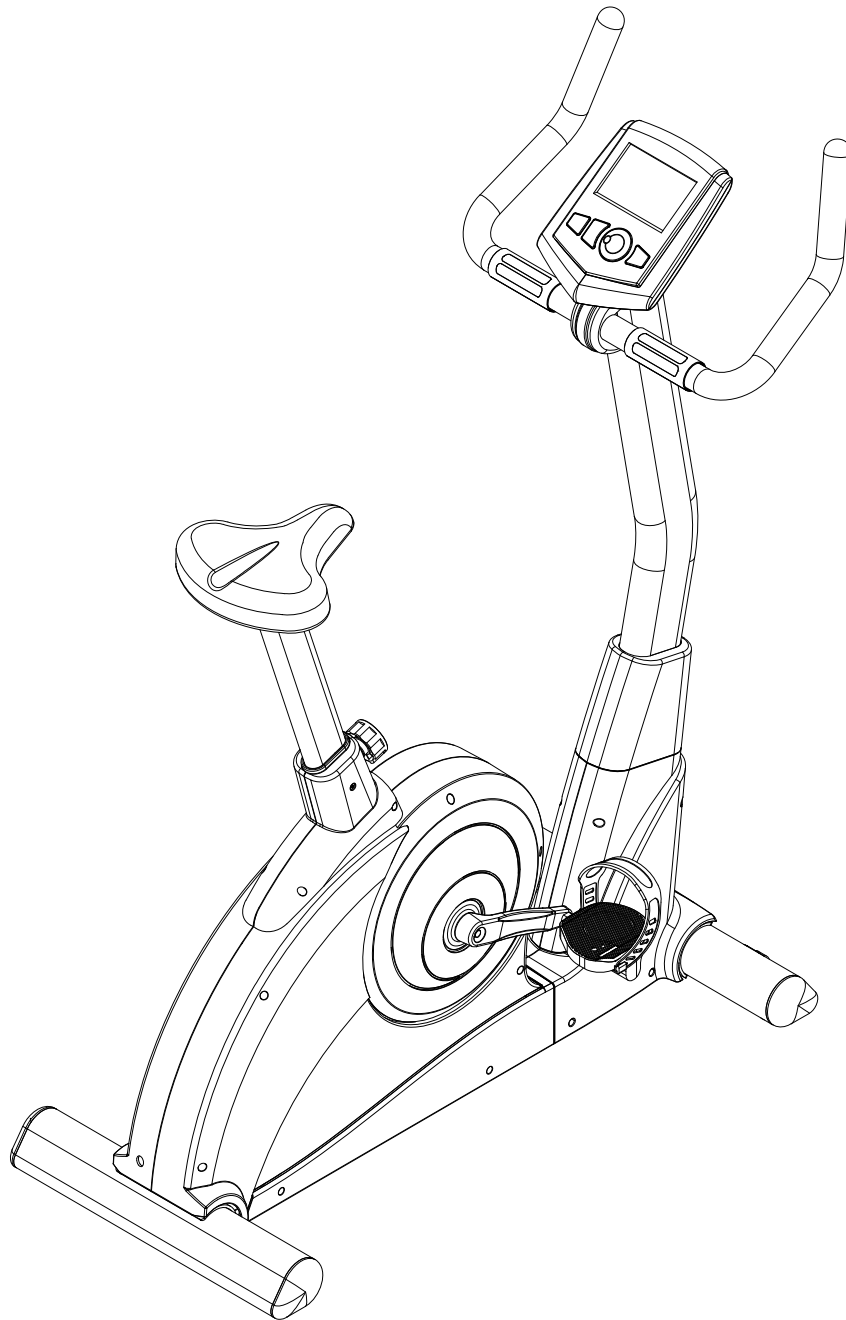

INDEX

IMPORTANT SAFETY NOTICE	P. 2
ASSEMBLY TOOLS & HARDWARE LIST	P. 3
ASSEMBLY INSTRUCTIONS	P. 4 - 6
COMPUTER INSTRUCTIONS	P. 7 - 14
COMPLETE PARTS LIST	P. 15
EXPLODED DIAGRAMS	P. 16 - 17

WARNING:

Before starting any exercise program, it is recommended that you consult your physician, especially for persons with pre-existing health problems. Before using the new equipment, please review this manual to learn about the features, functions, and safety operations. Should you experience any irregular physical conditions such as dizziness, severe muscle or joint pain, pain in your chest or should any other symptoms appear: **STOP EXERCISING** and consult with your physician immediately.

SAFETY TIPS AND PRECAUTIONS:

1. Read all instructions in this manual before using this equipment. It is the owner's responsibility to ensure that all users of this equipment are thoroughly informed of all warnings and precautions. Use this equipment for its intended use as described in this manual.
2. Securely tighten all nuts and bolts and inspect and tighten all parts each time you use the equipment. ***Replace any worn parts immediately and if you find that any repairs are needed, please keep the equipment out of use until repair.*
3. The safety level of the equipment can be maintained only if it is examined regularly for damage and wear.
4. The equipment should only be used on a level surface and is designed for indoor use only.
5. Warm up before you start exercising to prevent injuries
6. No more than one person should operate the equipment at one time.
7. Do not ride the equipment standing up.
8. It is recommended that you do not initiate any type of exercising within 40 minutes after a meal.
9. Keep small children and pets away from the equipment at all times
10. Appropriate clothing should be worn while exercising. Never wear loose clothing that could be caught in moving parts. It is recommended that athletic support clothing be worn for both men and women. Athletic shoes should always be worn while exercising. **DO NOT USE** with bare feet, wearing sandals, or wearing only socks or stockings.
11. Never use the equipment around water or while wet. Using the unit around a pool, hot tub or sauna will void the warranty and is potentially hazardous.

ASSEMBLY TOOLS & HARDWARE LIST

OPEN THE BOXES

Make sure to inventory all the parts that are included in the boxes. Check The Hardware Chart for a full count of the number of parts included for proper assembly.

GATHER YOUR TOOLS

Before starting the assembly of your unit, gather the necessary tools. Having all of the equipment at hand will save time and make the assembly quick and hassle-free.

CLEAR YOUR WORK AREA

Make sure that you have cleared away a large enough space to properly assemble the unit. Make sure the space is free from anything that may cause injury during assembly. After the unit is fully assembled, make sure there is a comfortable amount of free area around the unit for unobstructed operation.

Hardware chart

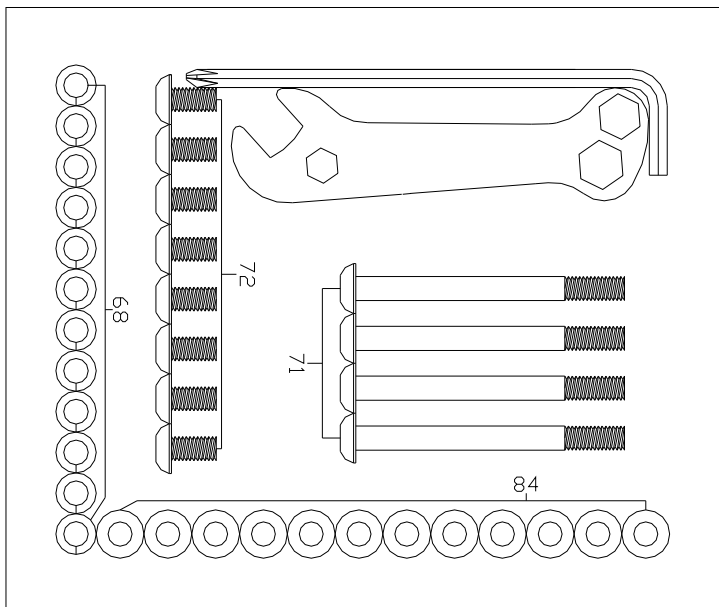

68	M8 SPRING WAHER	12
71	ROUND ALLEN HEAD BOLT M8 x 90MM	4
72	ROUND ALLEN HEAD BOLT M8 x 90MM	8
84	FLAT WASHER	12

ASSEMBLY INSTRUCTIONS

Step 1 - Attach Front Stabilizer

Attach Front Stabilizer (5) to Base Frame (1) and secure with:

- 2 – M8 Washers (84)
- 2 – M8 Spring Washers (68)
- 2 – M8 x 90MM Allen Head Bolt (71)

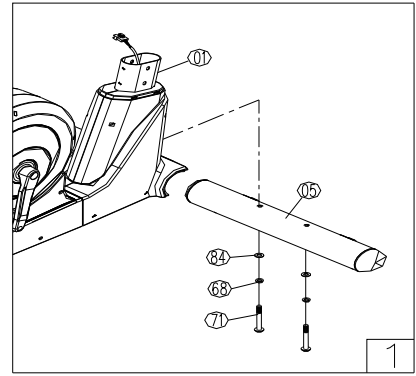

Step 2 - Attach Rear Stabilizer

Attach Rear Stabilizer (6) to Base Frame (1) and secure with:

- 2 – M8 Washers (84)
- 2 – M8 Spring Washers (68)
- 2 – M8 x 90MM Allen Head Bolt (71)

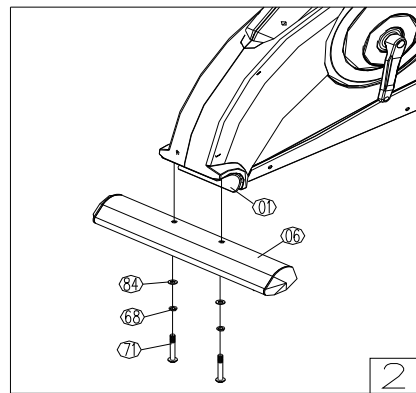

Step 3 - Install Handlebar post

Connect the Upper Computer Wire (47) to the Lower Computer Wire (46) .

Fit the Front Sleeve (21) onto the Handlebar post (2) and put it down after tighten with screw.

Attach Handlebar post (2) to the Main Frame (1) using:

- 4 – M8 Washers (84)
- 4 – M8 Spring Washers (68)
- 4 – M8 x 15MM Round Allen Head Bolt (72)

Note: Be careful not to damage or pinch wires when Handlebar Post is installed.

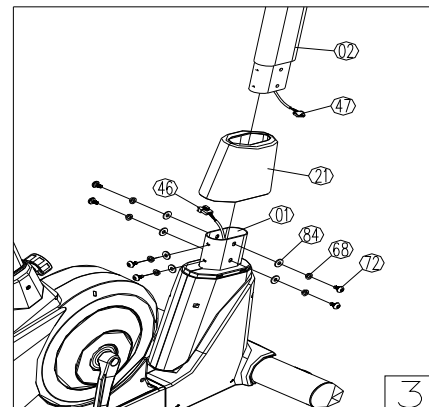

Step 4 - Install the Handlebar

Attach the handlebar (4) to Handlebar post (2) using:

- 4 – M8 Washers (84)
- 4 – M8 Spring Washers (68)
- 4 – M8 x 15MM Round Allen Head Bolt (72)

Attach Front handlebar cover (20) after screw tighten.

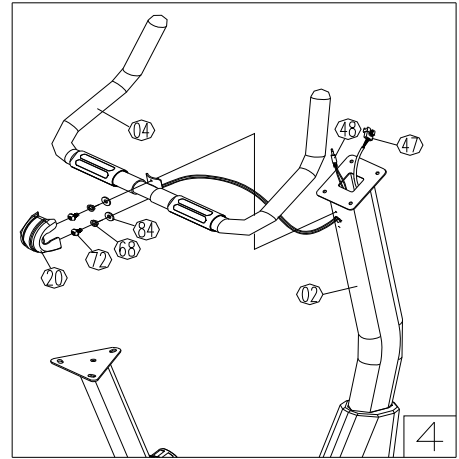

Step 5 - Install Computer

Connect the Upper Computer Wire (47) and Hand Pulse Wire (48) to the 2 wires that are on the back of the computer (15).

Attach the Computer to the Handlebar post (2) Using :

- 4 – M5 x 10MM Screws (125) (On back of Computer)

Note: Be careful not to damage or disconnect the wires when attaching the computer.

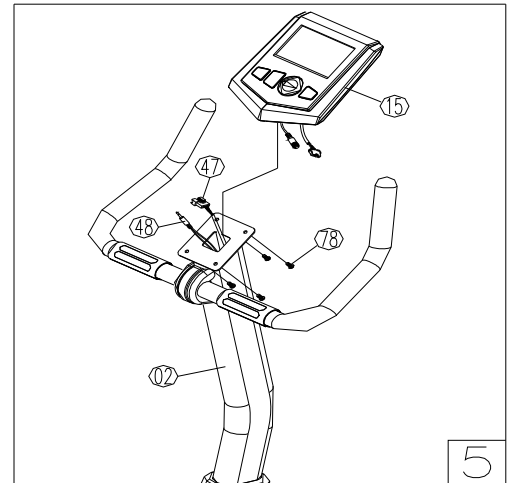

Step 6 - Install Seat

Attach Seat (14) to Seat post (03) using:

- 3 – M8 Flat Washer (88)
- 3 – M8 Nyloc Nut (66)

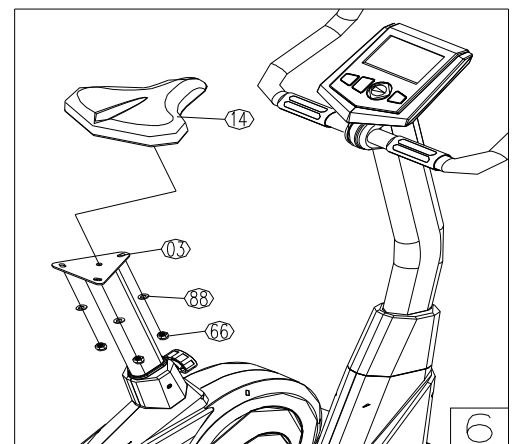

Step 7 –Install Pedals and Pedal Straps

Thread Right Pedal (8R) with an “R” onto the Right Crank Arm (7) in a clockwise direction.

Thread Left Pedal (8L) with an “L” onto the Left Crank Arm (7) in a counter-clockwise direction.

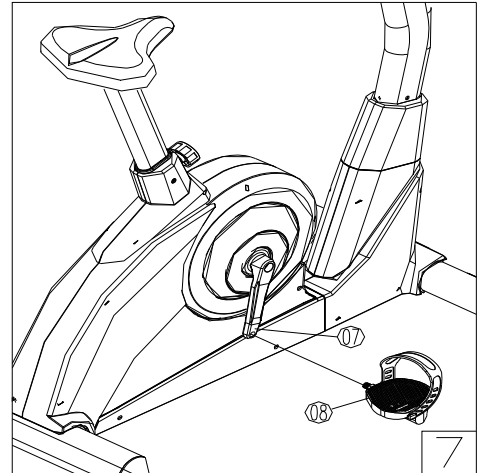

Step 8 – Plug the AC Adaptor

Plug the AC adaptor lead (95) into the socket at the rear end of your Upright Bike as shown.

Plug the 6V 1000mA A.C. Adaptor into a suitable mains supply.

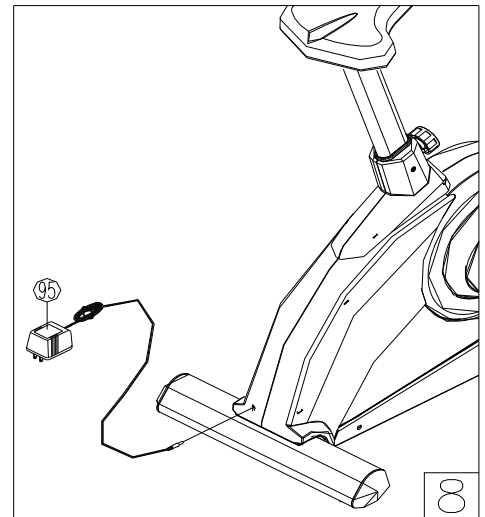

Leveling:

After completing the installation, if the floor or equipment is not even, turn the Adjustable Lever Knob (29) on the Front/Rear Foot (5 & 6) to the desired level in order to balance the frame.

Well done!

Your bike is now ready for use. Please continue to the computer section in this manual for instructions on how to operate your computer.

COMPUTER INSTRUCTIONS

DISPLAY CONSOLE OVERVIEW

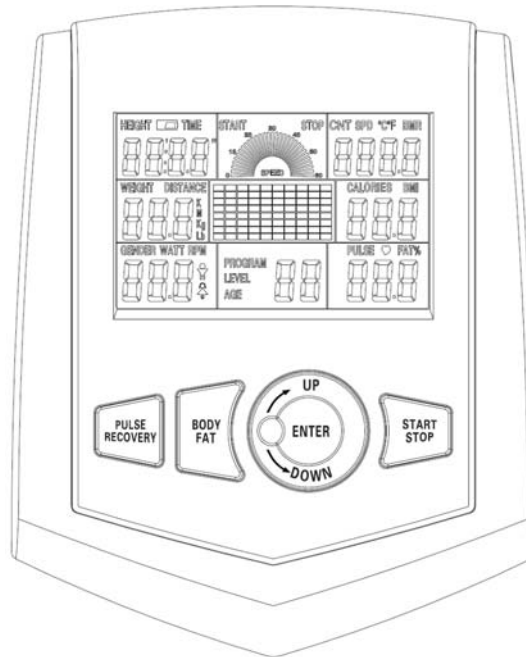

The things you should know before exercise

A. Input Power

Plug in the adaptor to the equipment then the computer will produce a beep sound and turn on the computer at the Manual mode.

B. Program select and setting value

1. Use the UP or DOWN keys to select program mode and then press ENTER to confirm your exercise mode.
2. At the Manual mode, the computer will use the UP or DOWN keys to set up your exercise TIME, DISTANCE, CALORIES, PULSE.
3. Press the START/STOP key to start exercise.
4. When you reach the target, the computer will produce beep sounds and then stop.
5. If you set up more than one target and you would like to reach next target, press START/STOP key to keep on exercise.

C. Wake-Up Function

The monitor will entry SLEEP mode (LCD off) when there is no signal input and no key be pressed after 4 minutes. Press the screen to start the monitor.

Functions and Features:

1. **TIME:** Shows your elapsed workout time in minutes and seconds. Your computer will automatically count up from 0:00 to 99:59 in one second intervals. You can also program your computer to count down from a set value by using the UP and DOWN keys. If you continue exercising once the time has reached 0:00, the computer will begin beeping, and reset itself to the original time set, letting you know your workout is done.
2. **DISTANCE:** Displays the accumulative distance traveled during each workout up to a maximum of 99.9KM/MILE.
3. **RPM:** Your pedal cadence.
4. **WATT:** The amount of mechanical power the computer is receiving from your exercise.
5. **SPEED:** Displays your workout speed value in KM/MILE per hour.
6. **CALORIES:** Your computer will estimate the cumulative calories burned at any given time during your workout.

7. PULSE: Your computer displays your pulse rate in beats per minute during your workout.
8. AGE: Your computer is age-programmable from 10 to 99 years. If you do not set an age, this function will always default to age 35.
9. TARGET HEART RATE (TARGET PULSE): The heart rate you should maintain is called your Target Hear Rate in beats per minute.
10. PULSE RECOVERY: During the START stage, leave the hands holding on grips or leave the chest transmitter attached and then press "PULSE RECOVERY" key, all function displays will stop except "TIME". Time starts counting from 00:60 - 00:59 - - to 00:00. As soon as 00:00 is reached, the computer will show your heart rate recovery status with the grade F1.0 to F6.0.

1.0 means OUTSTANDING

1.0 < F < 2.0 means EXCELLENT

2.0 ≤ F ≤ 2.9 means GOOD

3.0 ≤ F ≤ 3.9 means FAIR

4.0 ≤ F ≤ 5.9 means BELOW AVERAGE

6.0 means POOR

Note: If no pulse signal input then the computer will show "P" on the PULSE window. If the computer shows "ERR" on the message window, please re-press the PULSE RECOVERY key and please make sure your hands are keeping well on the grips or the chest transmitter is attached well.

11. TEMPERATURE: Display the current temperature.

Key function:

There are 6 button keys and the function description as follows:

1. START/STOP key:
 - a. Quick Start function: Allows you to start the computer without selecting a program. Manual workout only. Time automatically begins to count up from zero
 - b. During the exercise mode, press the key to STOP exercise.
 - c. During the stop mode, press the key to START exercise.
2. UP key:
 - a. Press the key to increase the resistance during exercise mode.
 - b. During the setting mode, press the key to increase the value of Time, Distance, Calories, Age and select Gender and Program.
3. DOWN key:
 - a. Press the key to decrease the resistance during exercise mode.
 - b. During the setting mode, press the key to decrease the value of Time, Distance, Calories, Age and select Gender and Program.
4. ENTER key:
 - a. During the setting mode, press the key to accept the current data entry.
 - b. At the stop mode, by holding this key for over two seconds the user can reset all values to zero or default value.
 - c. During setting the Clock, press this key can accept the setting hour and setting minute.
5. BODY FAT key: Press the key to input your HEIGHT, WEKGH, GENDER and AGE then to measure your body fat ratio,
6. PULSE RECOVERY key: Press the key to activate heart rate recovery function.

Program Introduction & Operation:

Manual Program: Manual

P1 is a manual program. User can start exercise by pressing START/STOP key. The default resistance level is 5. Users may exercise in any desirous of resistance level (Adjusting by UP/DOWN keys during the workout) with a period of time or a number of calories or a certain distance.

- Operations:**
1. Use UP/DOWN keys to select the MANUAL (P1) program.
 2. Press the ENTER key to enter MANUAL program.
 3. The TIME will flash and you can press UP or DOWN keys to set your exercise TIME. Press ENTER key to confirm your desired TIME.
 4. The DISTANCE will flash and you can press UP or DOWN keys to set your target DISTANCE. Press ENTER key to confirm your desired DISTANCE.
 5. The CALORIES will flash and you can press UP or DOWN keys to set your exercise CALORIES. Press ENTER key to confirm your desired CALORIES.
 6. The PULSE will flash and then you can press UP or DOWN keys to set your exercise PULSE. Press ENTER key to confirm your desired Pulse.

7. Press the START/STOP key to begin exercise.

Preset Program: Steps, Hill, Rolling, Valley, Fat Burn, Ramp, Mountain, Intervals, Random, Plateau, Fartlek, Precipice Program

PROGRAM 2 to PROGRAM 13 is the preset programs. Users can exercise with different level of loading in different intervals as the profiles show. Users may exercise in any desirous of resistance level (Adjusting by UP/DOWN keys during the workout) with a period of time or a number of calories or a certain distance.

Operations: 1. Use UP/DOWN keys to select one of the above programs from P2 to P13.

2. Press the ENTER key to enter your workout program.
3. The TIME will flash and you can press UP or DOWN keys to setting your exercise TIME. Press ENTER key to confirm your desired TIME.
4. The DISTANCE will flash and you can press UP or DOWN keys to setting your target DISTANCE. Press ENTER key to confirm your desired DISTANCE.
5. The CALORIES will flash and you can press UP or DOWN keys to setting your exercise CALORIES. Press ENTER key to confirm your desired CALORIES.
6. The PULSE will flash and then you can press UP or DOWN keys to set your exercise PULSE. Press ENTER key to confirm your desired Pulse.
7. Press the START/STOP key to begin exercise.

User Setting Program: User 1, User 2, User 3, User 4

Program 14 to 17 is the user setting program. Users are free to create the values in the order of TIME, DISTANCE, CALORIES and the resistance level in 10 columns. The values and profiles will be stored in the memory after setup. Users may also change the ongoing loading in each column by UP/DOWN keys, and they will not change the resistance level stored in the memory.

Operations: 1. Use UP/DOWN keys to select the USER program from P14 to P17.

2. Press the ENTER key to enter your workout program.
3. The column 1 will flash, and then use the UP/DOWN keys to create your personal exercise profile. Press ENTER to confirm your first column of exercise profile. The default level is load 1.
4. The column 2 will flash, and then use the UP/DOWN keys to create your personal exercise profile. Press ENTER to confirm your second column of exercise profile.
5. Follow the above description 5 and 6 to finish your personal exercise profiles. Press ENTER to confirm your desired exercise profile.
6. The TIME will flash and you can press UP or DOWN keys to setting your exercise TIME. Press ENTER key to confirm your desired TIME.
7. The DISTANCE will flash and you can press UP or DOWN keys to setting your target DISTANCE. Press ENTER key to confirm your desired DISTANCE.
8. The CALORIES will flash and you can press UP or DOWN keys to setting your exercise CALORIES. Press ENTER key to confirm your desired CALORIES.
9. The PULSE will flash and then you can press UP or DOWN keys to set your exercise PULSE. Press ENTER key to confirm your desired Pulse.
10. Press the START/STOP key to begin exercise.

Heart Rate Control Program: 55% H.R.C., 65% H.R.C., 75% H.R.C., 85% H.R.C., Target H.R.C.

Program 18 to Program 22 is the Heart Rate Control Programs and Program 22 is the Target Heart Rate Control program.

Program 18 is the 55% Max H.R.C. - - Target H.R. = $(220 - \text{AGE}) \times 55\%$

Program 19 is the 65% Max H.R.C. - - Target H.R. = $(220 - \text{AGE}) \times 65\%$

Program 20 is the 75% Max H.R.C. - - Target H.R. = $(220 - \text{AGE}) \times 75\%$

Program 21 is the 85% Max H.R.C. - - Target H.R. = $(220 - \text{AGE}) \times 85\%$

Program 22 is the Target H.R.C. - - Workout by your target heart rate value.

Users can exercise according to your desired Heart Rate program by setting your AGE, TIME, DISTANCE, CALORIES or TARGET PULSE. In these programs, the computer will adjust the resistance level according to the heart rate detected. For example, the resistance level may increase every 20 seconds while the heart rate detected is lower than the TARGET H.R and then the computer will show "SLOW DOWN" on the message window. Also the resistance level may decrease every 20 seconds while the heart rate detected is higher than the TARGET H.R and then the computer will show "HURRY UP" on the message window. As a result, the

user's heart rate will be adjusted to close the TARGET H.R. between the range of TARGET H.R. +5 and TARGET H.R. -5 and then the computer will show "KEEP GOING" on the message window.

- Operations:**
1. Use UP/DOWN keys to select one of the heart rate control program from P18 to P22.
 2. Press the ENTER key to enter your workout program
 3. The AGE will flash at P18 to P21 programs and you can press UP or DOWN keys to set your AGE. The default age is 35.
 4. At program 22, the TARGET PULSE will flash and you can press UP or DOWN keys to set your TARGET PULSE between 80 to 180. The default TARGET PULSE is 120.
 5. The TIME will flash and you can press UP or DOWN keys to set your exercise TIME. Press ENTER key to confirm your desired TIME.
 6. The DISTANCE will flash and you can press UP or DOWN keys to set your target DISTANCE. Press ENTER key to confirm your desired DISTANCE.
 7. The CALORIES will flash and you can press UP or DOWN keys to set your exercise CALORIES. Press ENTER key to confirm your desired CALORIES.
 8. Press the START/STOP key to begin exercise.

Watt Control Program: Watt Control

Program 23 is a Speed Independent Program. Press ENTER key to set up the values of TARGET WATT, TIME, DISTANCE and CALORIES. During the exercise mode, the level of resistance is not adjustable. For example, the level of resistance may increase while the speed is too slow. Also the level of resistance may decrease while the speed is too fast. As a result, the calculated value of WATT will close to the value of TARGET WATT setup by users.

- Operations:**
1. Use UP or DOWN key to select the WATT CONTROL (P23) program.
 2. Press ENTER key to enter your workout program.
 3. The TIME will flash and you can press UP or DOWN key to set your exercise TIME. Press ENTER key to confirm your desired TIME.
 4. The DISTANCE will flash and you can press UP or DOWN key to set your target DISTANCE. Press ENTER key to confirm your desired DISTANCE.
 5. The WATT will flash and you can press UP or DOWN key to set your target WATT value. Press ENTER key to confirm your target WATT. The default WATT value is 100.
 6. The CALORIES will flash and you can press UP or DOWN key to set your exercise CALORIES. Press ENTER key to confirm your desired CALORIES.
 7. The PULSE will flash and then you can press UP or DOWN keys to set your exercise PULSE. Press ENTER key to confirm your desired Pulse.
 8. Press the START/STOP key to begin exercise.

- NOTE:**
1. $WATT = TORQUE (KGM) * RPM * 1.03$
 2. In this program, the WATT value will keep constant value. It means that if you peddle quickly, the resistance level will decrease and if you peddle slowly, the resistance level will increase. Always try to keep you in the same watt value.

Body Fat Program: Body Fat

Program 24 is a special program design to calculate users' body fat ratio and to offer a specific loading profile for users. There are 3 body types divided according to the FAT% calculated.

Type1: BODY FAT% > 27

Type2: $27 \geq \text{BODY FAT\%} \geq 20$

Type3: BODY FAT % < 20

The computer will show the test results of FAT PERCENT, BMI and BMR.

- Operations:**
1. Use UP/DOWN keys to select the BODY FAT (P24) program.
 2. Press the ENTER key to enter your workout program.
 3. The HEIGHT will flash and you can press UP or DOWN keys to set your HEIGHT. Press ENTER key to confirm your HEIGHT. The default HEIGHT is 170cm or 5'07" (5feet 7 inches).
 4. The WEIGHT will flash and you can press UP or DOWN keys to set your WEIGHT. Press ENTER key to confirm your WEIGHT. The default WEIGHT is 70kgs or 155lbs.
 5. The GENDER will flash and you can press UP or DOWN keys to select your sex. Number 1 means man and number 0 means female. Press ENTER key to confirm your Gender. The default sex is 1 (MAN).

6. The AGE will flash and you can press UP or DOWN keys to set your AGE. Press ENTER key to confirm your AGE. The default AGE is 35.
7. Press the START/STOP key to begin body fat measurement. If the window show E on the window, please make sure your hands are attached well on the grips or the chest belt is touch well on your body. Then press the START/STOP key again to begin body fat measurement.
8. After finished your measurement, the computer will show the values of BMR, BMI and FAT PERCENT on the LCD display. Furthermore, the computer will show your own exercise profile for your body type.
9. Press START/STOP key to begin exercise.

Operation guide:

1. Sleep Mode:

The computer will enter the sleep mode when there is no signal input and no keys be pressed after 4 minutes. You can press any key to wake up the computer.

2. BMI (Body Mass Index): BMI is a measure of body fat based on height and weight that applies to both adult men and women.
3. BMR (Basal Metabolic Rate): Your Basal Metabolic Rate (BMR) shows the number of calories your body needs to operate. This doesn't account for any activity, it's simply the energy needed to sustain a heartbeat, breathing and normal body temperature. It measures the body at rest, not sleep, at room temperature.

Error Message:

E1 (ERROR 1):

Normal state: During workout, when the monitor did not get the count signal from the gear motor more than 4 seconds and check under successive 3 times then the LCD will show E1.

Power on state: The gear motor will return to zero automatically, when the signal of motor cannot be detected for more than 4 seconds then the gear motor's driver will be cut off immediately and show the E1 on the LCD display. All the other digital and function mark are blank, and the output signals are cut off also.

E2 (ERROR 2): When the monitor read the memory data, if the I.D. code is not correct or the memory IC damages then the monitor will show E2 immediately at power on.

E3 (ERROR 3): After 4 seconds by start mode, the computer detects the faulty motor did not leave the zero point then the LCD bar displays "E3".

Technical data of the current adapter

1. Available for Input: 230V/50Hz or 60Hz Output: 6V AC/0.5A
2. Available for Input: 110V/50Hz or 60Hz Output: 6V AC/0.5A

LCD Workout Graphics

PRESET PROGRAM PROFILES:

PROGRAM 1

MANUAL

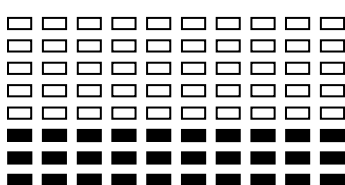

PROGRAM 2

STEPS

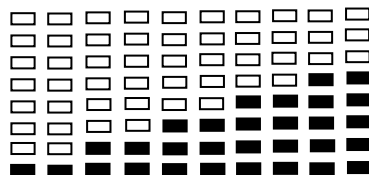

PROGRAM 3

HILL

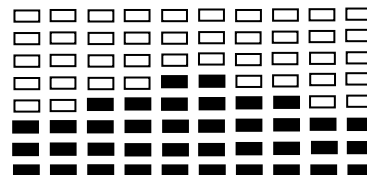

PROGRAM 4

ROLLING

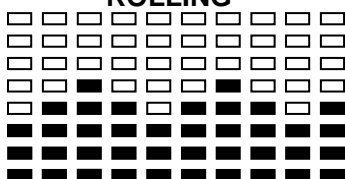

PROGRAM 5

VALLEY

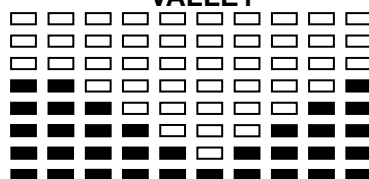

PROGRAM 6

FAT BURN

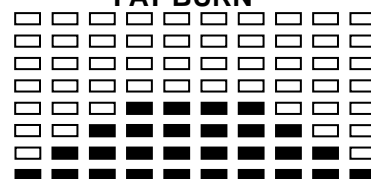

PROGRAM 7

RAMP

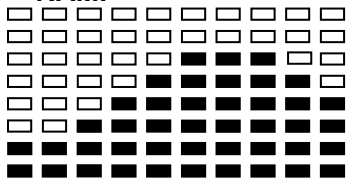

PROGRAM 8

MOUNTAIN

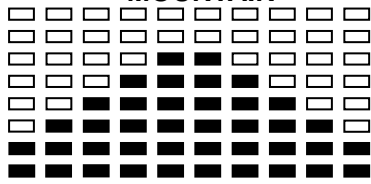

PROGRAM 9

INTERVALS

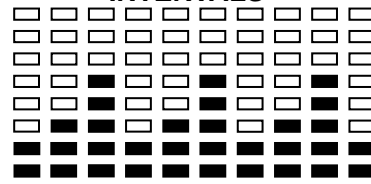

PROGRAM 10

RANDOM

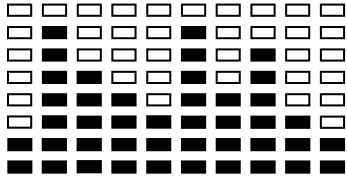

PROGRAM 11

PLATEAU

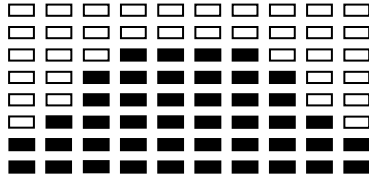

PROGRAM 12

FARTLEK

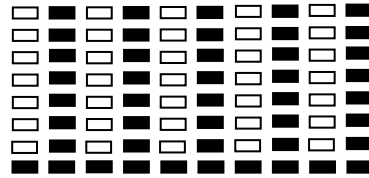

PROGRAM 13

PRECIPICE

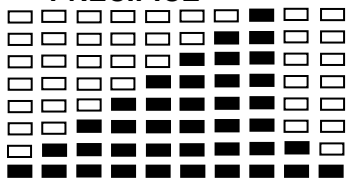

USER SETTING PROGRAM

PROGRAM 14

USER 1

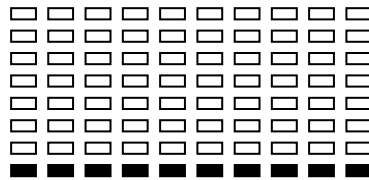
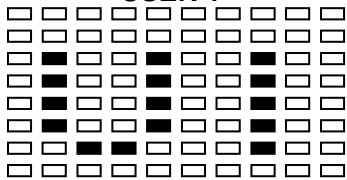

PROGRAM 15

USER 2

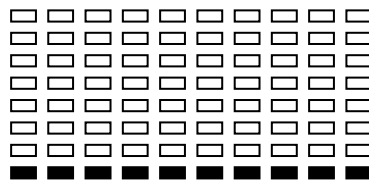
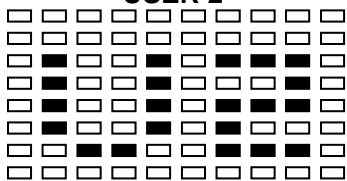

PROGRAM 16

USER 3

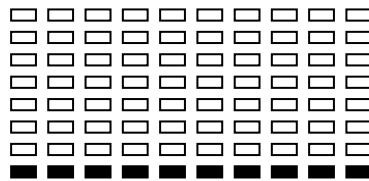
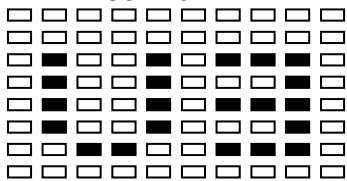

PROGRAM 17

USER 4

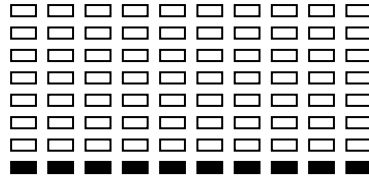
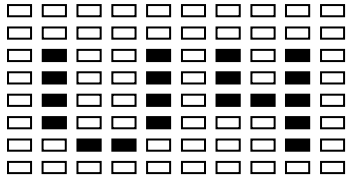

HEART RATE PROGRAM PROFILES:

PROGRAM 18

55% H.R.C.

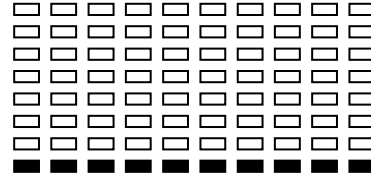
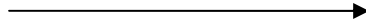
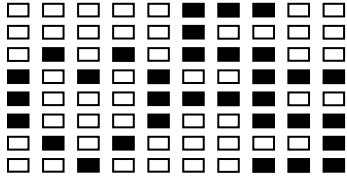

PROGRAM 19

65% H.R.C.

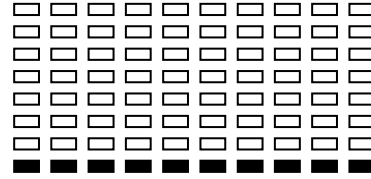
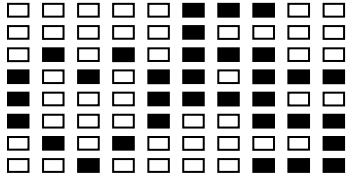

PROGRAM 20

75% H.R.C.

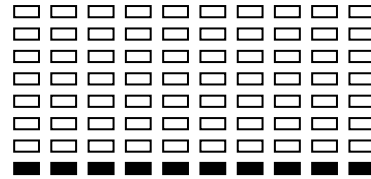
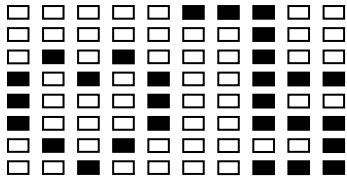

PROGRAM 21

85% H.R.C.

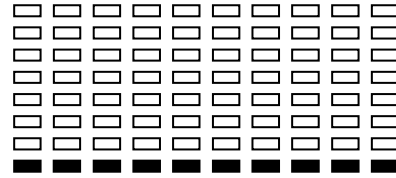
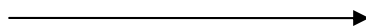
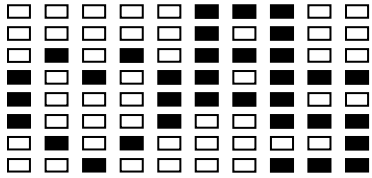

PROGRAM 22

TARGET H.R.C.

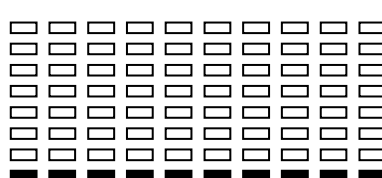
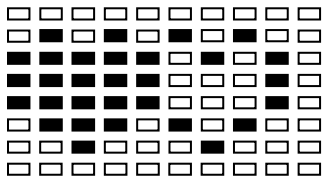

WATT CONTROL PROGRAM

PROGRAM 23

WATT CONTROL

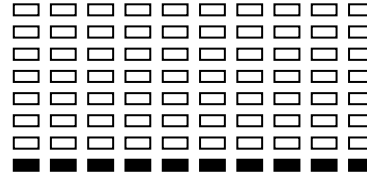
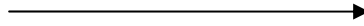
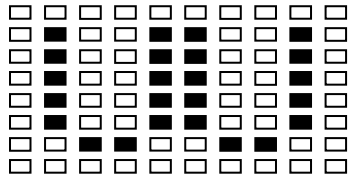

BODY FAT TEST PROGRAMS:

PROGRAM 24

BODY FAT (STOP MODE)

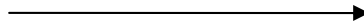
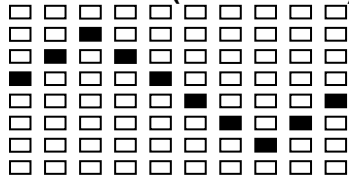

BODY FAT (START MODE)

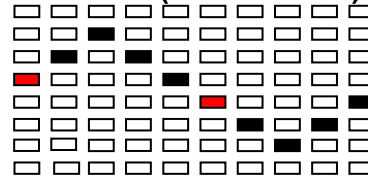

One of the Following Six Profiles Will Display Automatically after Measuring Your BODY FAT:

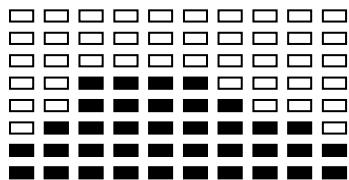

Workout Time: 40 minutes

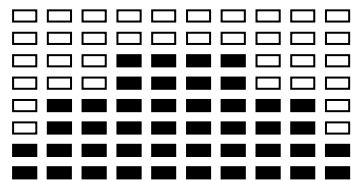

Workout Time: 40 minutes

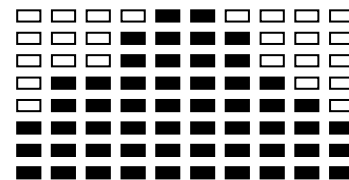

Workout time: 20 minutes

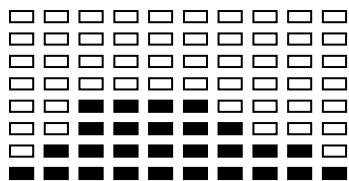

Workout Time: 40 minutes

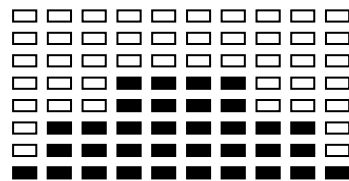

Workout Time: 40 minutes

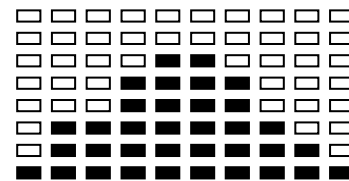

Workout time: 20 minutes

COMPLETE PARTS LIST

NO.	DESCRIPTION	QTY	NO.	DESCRIPTION	QTY
1	BASE FRAME	1	49	SENSOR WIRE	1
2	UPRIGHT TUBE	1	50	DC WIRE	1
3	SEAT POST	1	51	SERVO MOTOR	1
4	HANDLEBAR	1	52	SENSOR BRACKET	1
5	FRONT FOOT	1	53	ONE WAY BEARING	1
6	REAR FOOT	1	54	6001 BEARING	1
7	CRANK SET (L/R)	1	55	6003 BEARING	2
8	PEDAL SET (L/R)	1	56	6000 BEARING	1
9	CRANK CAP	2	57	6300 BEARING	1
10	MOVING WHEEL	2	58	6203 BEARING	2
11	FRONT/REAR FOOT CAP	4	59	C10 C CLIP	2
12	SEAT ADJUST KNOB	1	60	C17 C CLIP	2
13	SEAT POST INSERT	1	61	C12 C CLIP	1
14	SEAT	1	62	3/8" WH NUT	2
15	CONSOLE	1	63	HEX TAPER NUT (3/8")	1
16	END CAP FOR HANDLEBAR	2	64	HEX TAPER NUT (M6)	2
17	FOAM GRIP	2	65	NYLOC NUT (M8) - BLACK	2
18	HAND PULSE SENSOR	2	66	NYLOC NUT (M8)	3
19	CONTACT HR PLASTIC	2	67	NYLOC NUT (M6)	5
20	FRONT HANDLEBAR COVER	1	68	M8 SPRING WASHER	12
21	FROTN SLEEVE	1	69	M8 SPRING WASHER - BLACK	2
22	FRONT HOUSING - LEFT	1	70	HEX HEAD SHOULDER BOLT (M8 x 25mm)	2
23	FRONT HOUSING - RIGHT	1	71	ROUND ALLEN HEAD BOLT (M8 x 90mm)	4
24	REAR SLEEVE - LEFT	1	72	ROUND ALLEN HEAD BOLT (M8 x 15mm)	8
25	REAR SLEEVE - RIGHT	1	73	HEX HEAD BOLT (M8 x 16mm)	2
26	MAIN HOUSING - LEFT	1	74	HEX HEAD BOLT (M8 x 25mm)	1
27	MAIN HOUSING - RIGHT	1	75	HEX HEAD BOLT (M6 x 18mm)	4
28	BOLT (3/8"-16)	4	76	HEX HEAD BOLT (M8 x 52mm)	1
29	HEIGHT ADJUSTING FOOT	4	77	HEX HEAD BOLT (M6 x 70mm)	1
30	FIX BRACKET	2	78	ROUND PHILIPS HEAD MACHINE SCREW (M5 x 10mm)	8
31	IDLE WHEEL BRACKET	1	79	ROUND PHILIPS HEAD SELF TAPPING SCREW (M4 x 20mm)	7
32	IDLE WHEEL	1	80	ROUND PHILIPS HEAD SELF TAPPING SCREW (#10 x 19mm)	8
33	ADJUST BKT FOR MAGNET SET	1	81	ROUND PHILIPS HEAD SELF TAPPING SCREW (#6 x 12mm)	3
34	FLYWHEEL AXLE	1	82	ROUND PHILIPS HEAD SELF TAPPING SCREW (M4 x 15mm)	4
35	FLYWHEEL	1	83	ROUND PHILIPS HEAD SELF DRILLING SCREW (M8 x 16mm)	4
36	SMALL PULLEY	1	84	FLAT WASHER (ID-8 x OD-16mm)	12
37	POLY-V BELT	1	85	FLAT WASHER (ID-8 x OD-16mm)	2
38	PULLEY AXLE	1	86	FLAT WASHER (ID-6 x OD-16mm)	1
39	PULLEY	1	87	FLAT WASHER (ID-8 x OD-22mm)	1
40	MAGNET	1	88	FLAT WASHER (ID-8 x OD-16mm)	3
41	DC WIRE BRACKET	1	89	NYLON WASHER	2
42	MAGNET SET	1	90	NYLON WASHER	1

43	ROPE	1	91	SCREW M6 x 25mm	1
44	COMPRESSION SPRING	1	92	ROUND PHILIPS HEAD SELF TAPPING SCREW (M4 x 25mm)	2
45	TENSION SPRING	1	93	ROUND PHILIPS HEAD SELF TAPPING SCREW (5 x 12mm)	2
46	LOWER COMPUTER WIRE	1	94	NULOC NUT 3/8"	1
47	UPPER COMPUTER WIRE	1	95	ADAPTOR	1
48	HAND PULSE WIRE	1			

EXPLODED DIAGRAM 1

*** MANY OF THE PARTS SHOWN HERE HAVE BEEN PRE-ASSEMBLED.**

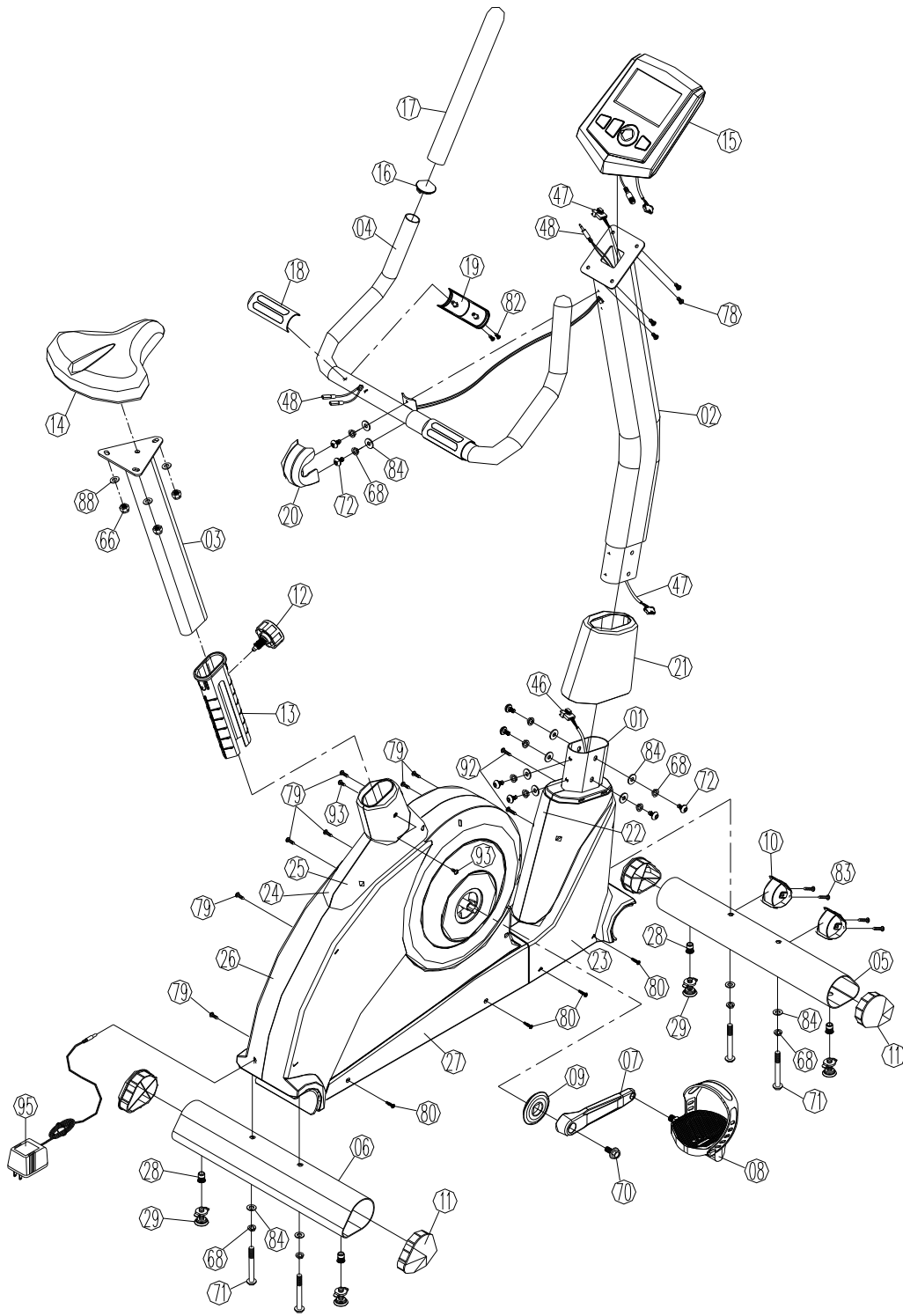

EXPLODED DIAGRAM 2

* ALL THE PARTS SHOWN HERE HAVE BEEN PRE-ASSEMBLED.

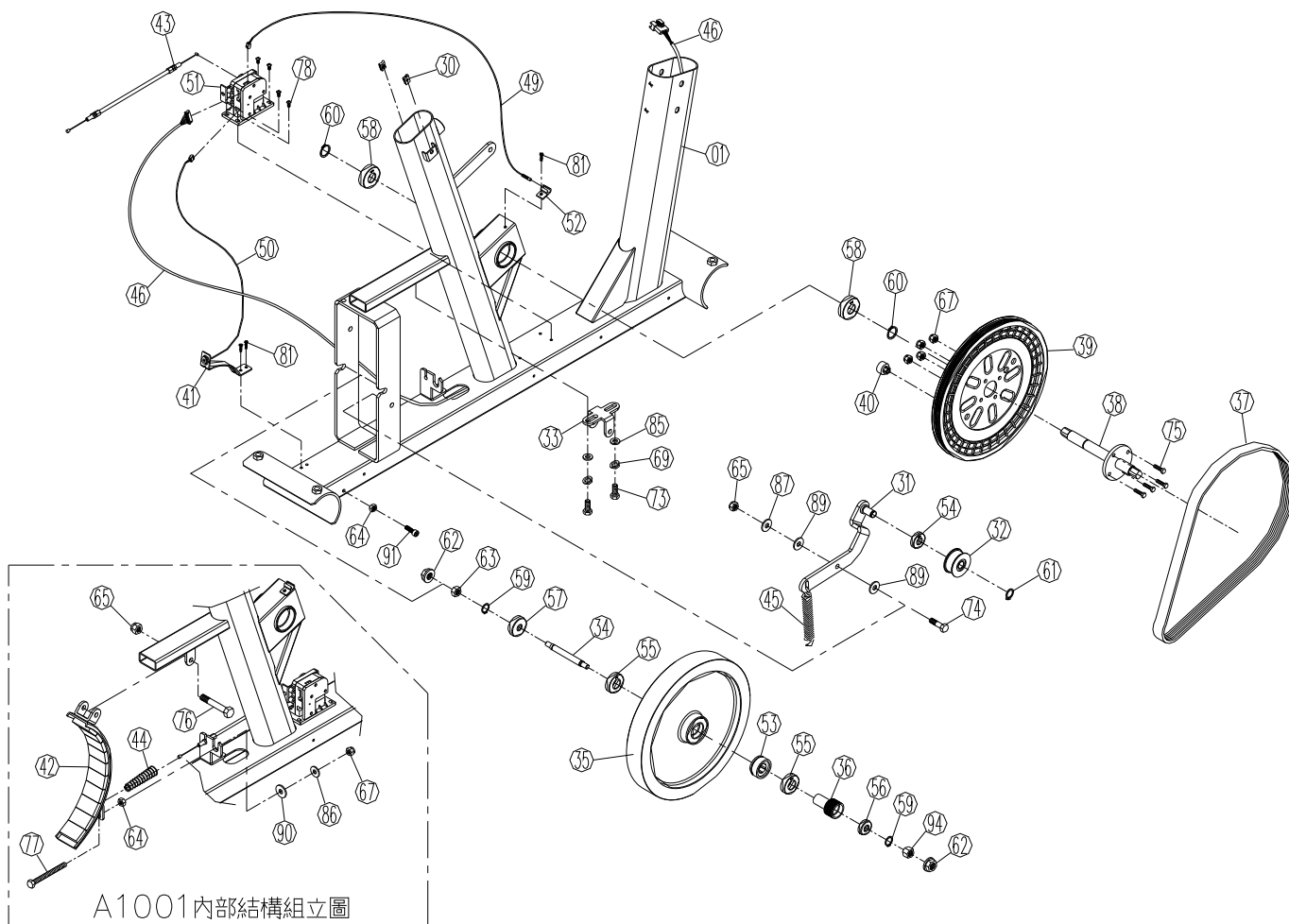

A1001内部結構組立圖